



SNOW LINE

**MecVel
electric linear
actuators:
technological
solutions for
automation in
winter sports and
rope-hauled
transportation
systems**



Since 1987 MecVel plays a key-role in the automation field, and its core business is the design and the production of electric linear actuators. These devices transform the rotatory motion of a motor into a push or pull movement for loads up to 20 tons.

BENEFITS OF MECVEL ELECTRIC SYSTEM

MecVel linear actuators offer:

- High precision in positioning, also in case of frequent repetition
- Excellent levels of safety thanks to optional devices for feedback and control as limit switches, encoder and potentiometer
- Possibility of full customization: this service has the purpose to tailor each product in its technical parts on customer needs
- Plug and play installation and remote control, matchable with the latest electronic devices
- Green technology as per industry 4.0 concepts of energetic efficiency and sustainable industrial production

Electric systems, unlike hydraulic and pneumatic ones, do not have particular use restrictions and performances are not influenced by:

- Variations in the level of oil flow or air pressure
- Contaminants leaks
- Large size components that require intensive maintenance

FOCUS ON THE SNOW FIELD

These are the handlings performed by MecVel electromechanical devices and the solutions proposed by these technologies:

- Ski lifts and rope-hauled transportation systems: operation of switching the cabin on a secondary rail for maintenance or storage. The electric linear actuator allows to automate the separation of the cabin from the main rail, to move it on a secondary one and transport it in the area dedicated to maintenance or technical operations, as well as the storage during the closure time of the ski lift or the rope-hauled transportation system, to preserve it from harsh climatic conditions
- Ski resorts: operation of opening and closing access doors and tilt blinds of the entire ski resort. Biggest sizes of MecVel range are the most suitable for these heavy handlings

MecVel combines its products with a series of optional that make them safe and reliable even with particular climatic conditions as low temperatures, snow and rain:

- Protective coating with corrosion class C5-M. These electric linear actuators are usually also painted with bright colors in order to be visible mostly in case of outdoor applications with particular sight conditions: for example when it snows a lot, or they're partially covered by the snow

Corrosion class	Indoor environments	Outdoor environments
C1 - very low	Heated buildings	Not applicable
C2 - low	Not-heated buildings with low pollution	Industrial area with low pollution
C3 - medium	High humidity and moderate pollution	Industrial areas with medium pollution
C4 - high	Chemical plants, swimming pools	Industrial areas with medium salinity
C5-I - very high/industrial	High humidity and pollution, aggressive atmosphere	Industrial areas with high pollution and humidity
C5-M - very high/marine	High humidity and pollution, aggressive atmosphere	Off-shore areas with high salinity

- Ice scrapers, heaters, protective external cover tubes and special lubricants are the options developed to face low temperature (also up to -40°C) keeping constant the efficiency of the electric linear actuator

MecVel electromechanical devices automate these handlings, increasing at the same time the efficiency and the technological level of the whole plant, but also its reliability. Its functionality, in fact, is ensured even with harsh climatic conditions and independently from the manual intervention of operators.

MECEVL PRODUCTS FOR THE SNOW FIELD

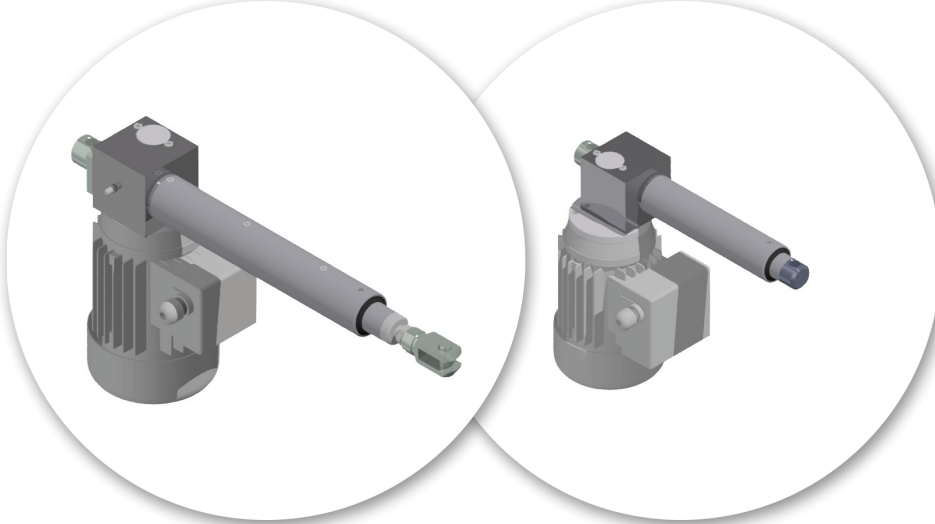

Standard models can be further developed to meet application requirements in terms of force/speed ratio, stroke length, power supply, accessories. The target is to perform the linear motion even in critical environments and with heavy loads.



ICE SCRAPER

MecVel electric linear actuators performances can be enhanced choosing ball screws combined with EC or HRS series, the most suitable also in case of long strokes.



EC SERIES

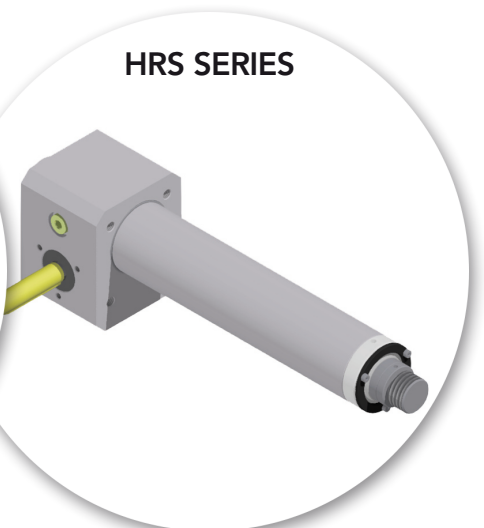

HRS SERIES