



Railway industry



Electric linear
actuators at
the service of
the railway
industry

MecVel Srl - Via Due Portoni 23, Bologna, Italy
info@mecvel.com - www.mecvel.com
© Copyright MecVel 2021

ELECTRIC LINEAR ACTUATORS AT THE SERVICE OF THE RAILWAY INDUSTRY

Since 1987 MecVel plays a key role in the automation field, and its core business is the design and the production of electric linear actuators. These devices transform the rotatory motion of a motor into a push or pull movement for loads up to 20 tons, and they perfectly meet the packaging industry, as it requires high-performing products, which use an electric and eco-sustainable system, really versatile.

In particular, this flexibility is given by the customization service of the company, able to configure each electric linear actuator to satisfy the technical specifications of the application to which it is intended.

MECVEL ELECTRIC SYSTEM'S ADVANTAGES

The high precision with which these products are manufactured turns into great efficiency, with the purpose to offer reliable and safe linear motion technologies to the railway industry. This makes possible the application to switching devices, wagons up to accessibility solutions provided on trains, to improve the usability by people with a reduced mobility capacity.

Moreover, MecVel has a customization service, developing flexible electric linear actuators, tailored according to the railway industry's technical needs, optimizing the linear automation. This also thanks to a powerful, compact, and eco-friendly electric system, suitable for outdoor use even with bad weather conditions.

FOCUS ON THE RAILWAY INDUSTRY

Electromechanical components such as electric linear actuators can be used in the transport industry, with a focus on railways, for both people transportation and goods logistic. These are some of the applications supplied by MecVel:

- Railroad switches
- Wagons
- Mobility
- Maintenance

MecVel linear actuators deliver a safe and precise movement even under the more extreme conditions, thanks to product certifications such as IP65 and AT-EX. In the railway industry, the actuators most common extra features are:

- Handwheel
- Flameproof cables
- High IP rating

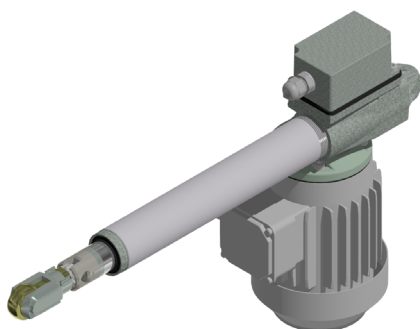

ALI2F

Wagons: automation of the door opening and closing.

ALI4

Railroad switches: handling of switching devices, for example, to guide the train on a secondary track when not in use or for maintenance operations.

ALI3F / ALI4

Maintenance: electric linear actuators are used to handle certain movements in some external machinery for wagon cleaning and maintenance

ALI1 / ALI3 / ALI4

Mobility: electric linear actuators are used to handle elevators, raise/lower platforms, to allow an easier transit of people with a reduced mobility capacity, or to load and unload heavy goods.

